

STATE	PROJECT NO.	SHEET NO.	TOTAL SHEETS
N.C.	2018CPT.10.10.10041,I-ETC. 2018CPT.10.10.20041,I-ETC.	1	
F.A. PROJECT NO.			

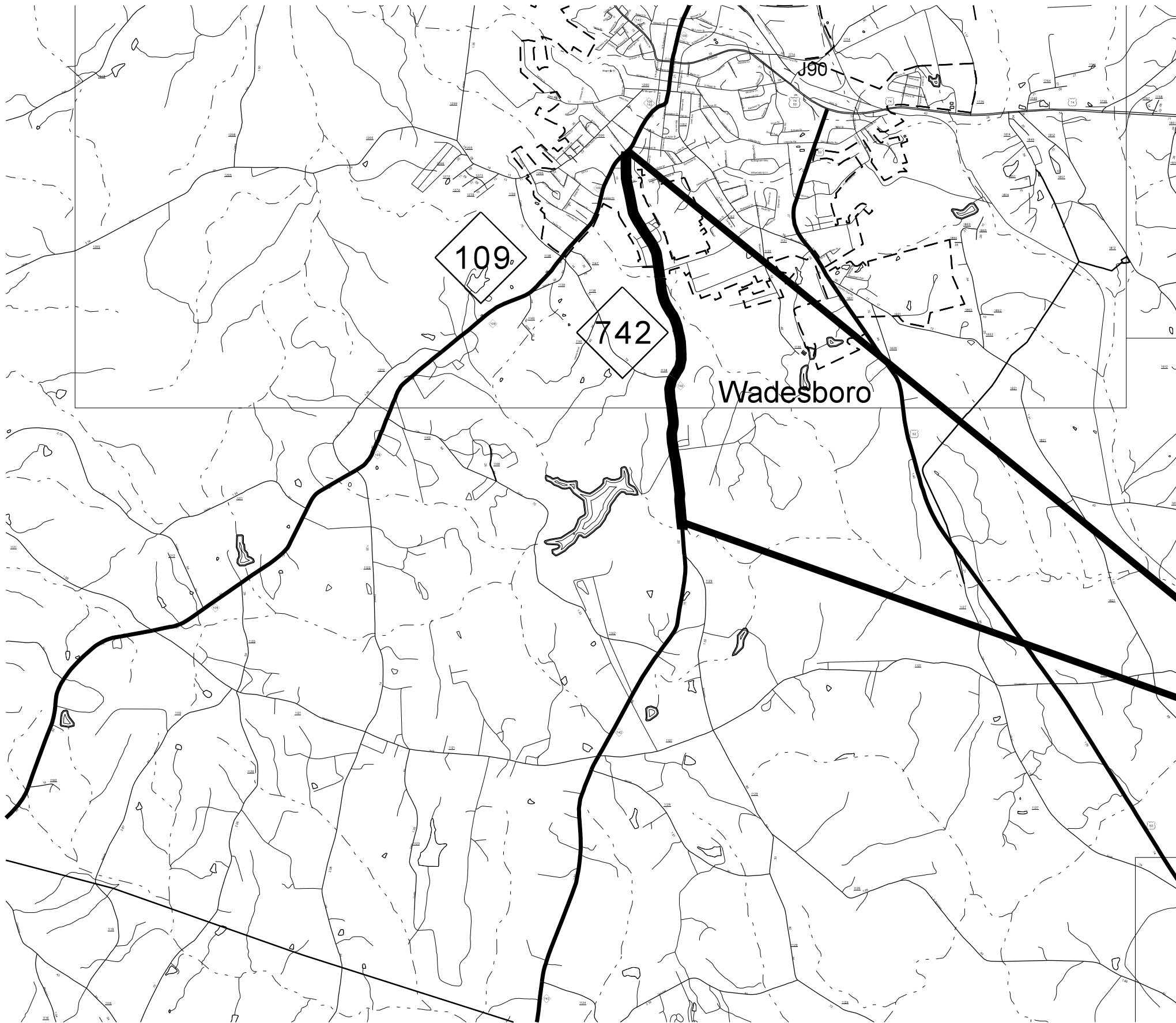

ENLARGED MUNICIPAL AND SUBURBAN AREAS
ANSON COUNTY
 NORTH CAROLINA
PREPARED BY THE
 NORTH CAROLINA DEPARTMENT OF TRANSPORTATION
 DIVISION OF HIGHWAYS - DIVISION 10 DISTRICT 3

**MAP #1 NC 742 SOUTH
 2.8 MILES**

FROM PAVEMENT JOINT AT BRIDGE TO NC109

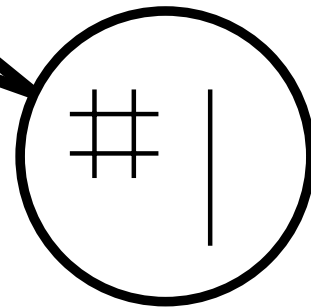

STATE	PROJECT NO.	SHEET NO.	TOTAL SHEETS
N.C.	2018CPT.10.10.1004I.I-ETC. 2018CPT.10.10.2004I.I-ETC.	2	
F.A. PROJECT NO.			

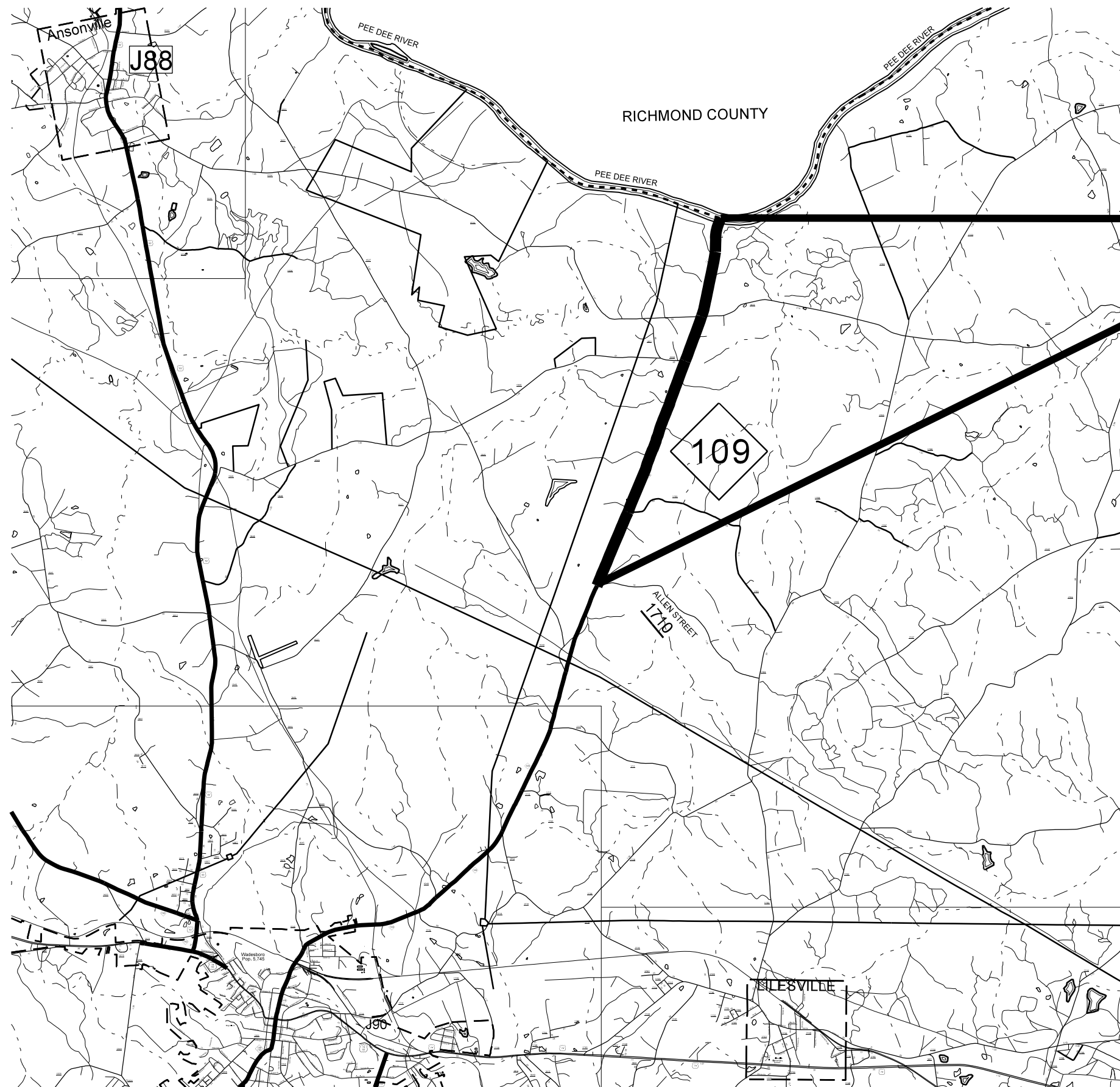

2



ENLARGED MUNICIPAL AND SUBURBAN AREAS
ANSON COUNTY
 NORTH CAROLINA
PREPARED BY THE
 NORTH CAROLINA DEPARTMENT OF TRANSPORTATION
 DIVISION OF HIGHWAYS - DIVISION 10 DISTRICT 3

MAP #2 NC 109 NORTH
 3.9 MILES

FROM PAVEMENT JOINT AT SR 1710 ALLEN STREET TO BRIDGE OVER PEE DEE RIVER

STATE	PROJECT NO.	SHEET NO.	TOTAL SHEETS
N.C.	2018CPT.10.10.1004I.1-ETC. 2018CPT.10.10.2004I.1-ETC.	3	
F.A. PROJECT NO.			

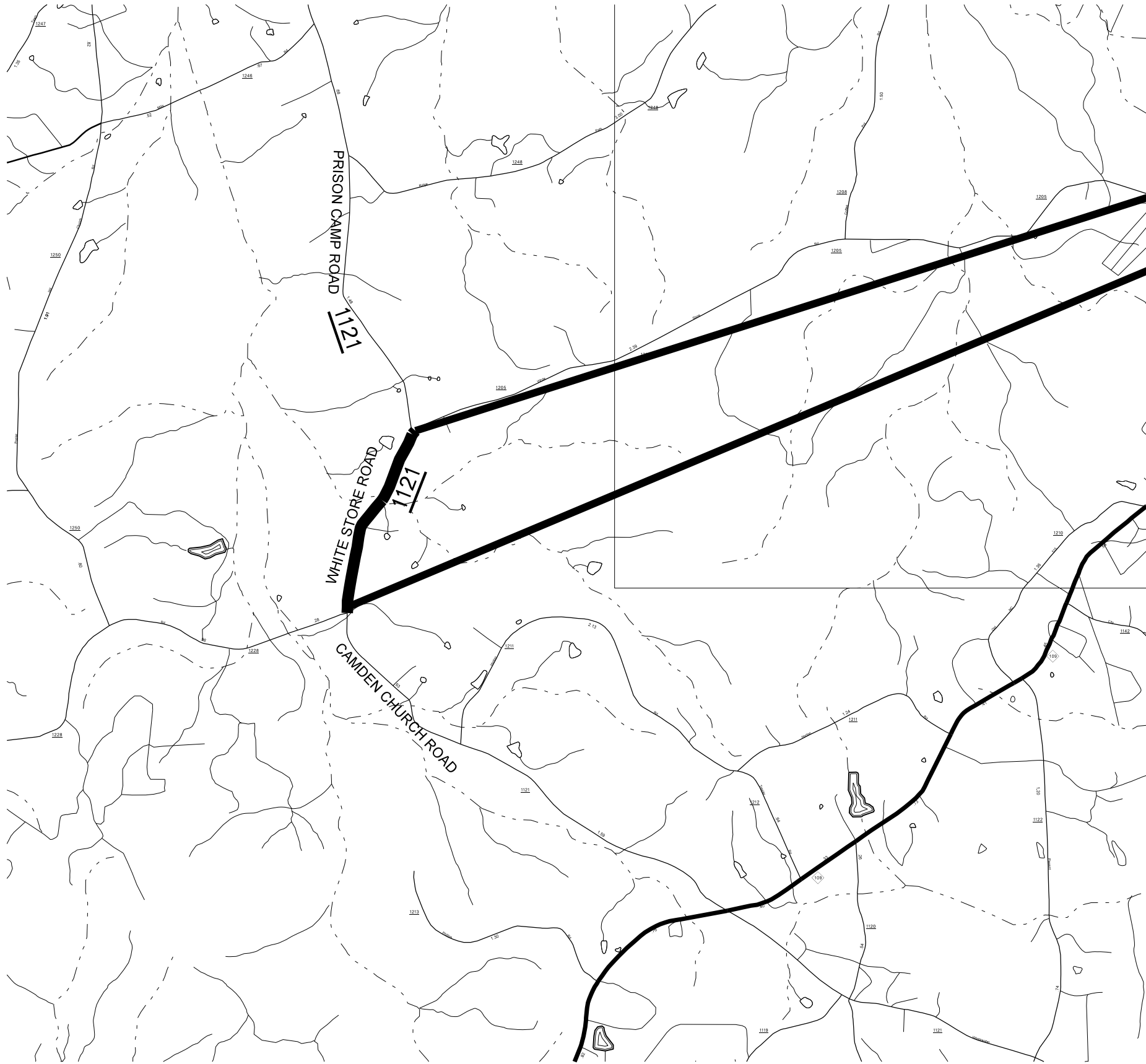

3



ENLARGED MUNICIPAL AND SUBURBAN AREAS
ANSON COUNTY
 NORTH CAROLINA
PREPARED BY THE
 NORTH CAROLINA DEPARTMENT OF TRANSPORTATION
 DIVISION OF HIGHWAYS - DIVISION 10 DISTRICT 3

MAP #3 SR 1121 WHITE STORE ROAD
 1.0 MILES

FROM SR 1121 PRISON CAMP ROAD
 TO PAVEMENT JOINT AT
 SR 1121 CAMDEN CHURCH ROAD

4

UNION COUNTY

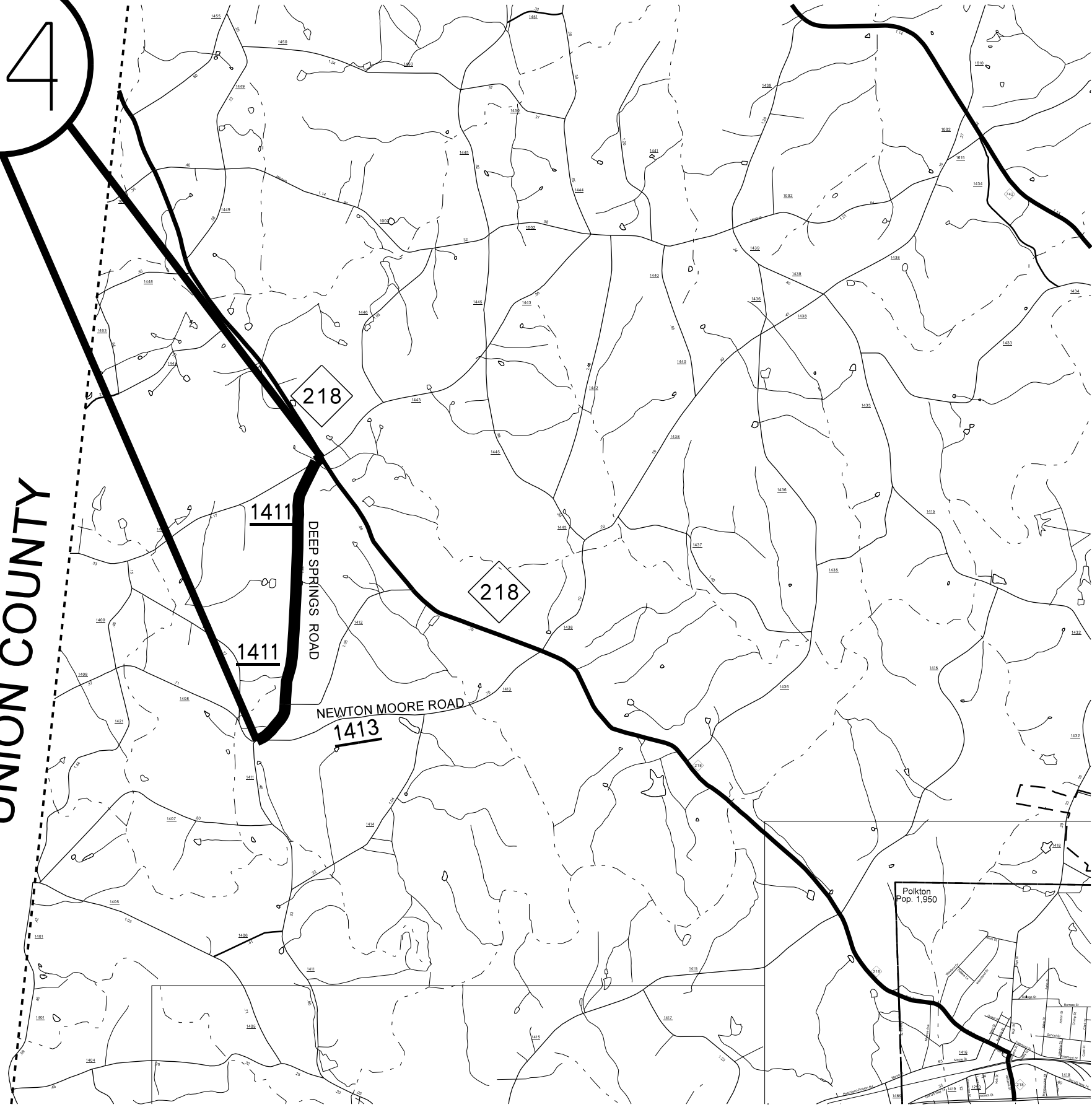

STATE	PROJECT NO.	SHEET NO.	TOTAL SHEETS
N.C.	2018CPT.10.10.1004I-I-ETC. 2018CPT.10.10.2004I-I-ETC.	4	
F.A. PROJECT NO.			



ENLARGED MUNICIPAL AND SUBURBAN AREAS

ANSON COUNTY

NORTH CAROLINA

PREPARED BY THE
NORTH CAROLINA DEPARTMENT OF TRANSPORTATION
DIVISION OF HIGHWAYS - DIVISION 10 DISTRICT 3

MAP #4 SR 1411 DEEP SPRINGS ROAD
1.6 MILES

FROM SR 1413 NEWTON MOORE ROAD
TO NC 218

STATE	PROJECT NO.	SHEET NO.	TOTAL SHEETS
N.C.	2018CPT.10.10.1004I-I-ETC. 2018CPT.10.10.2004I-I-ETC.	5	
F.A. PROJECT NO.			

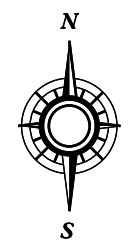

ENLARGED MUNICIPAL AND SUBURBAN AREAS
ANSON COUNTY
 NORTH CAROLINA
PREPARED BY THE
 NORTH CAROLINA DEPARTMENT OF TRANSPORTATION
 DIVISION OF HIGHWAYS - DIVISION 10 DISTRICT 3

MAP #5 SR 1003 DEEP CREEK ROAD
2.6 MILES
FROM NC 109 SOUTH TO SR 1113
CEDAR CREEK ROAD

#5

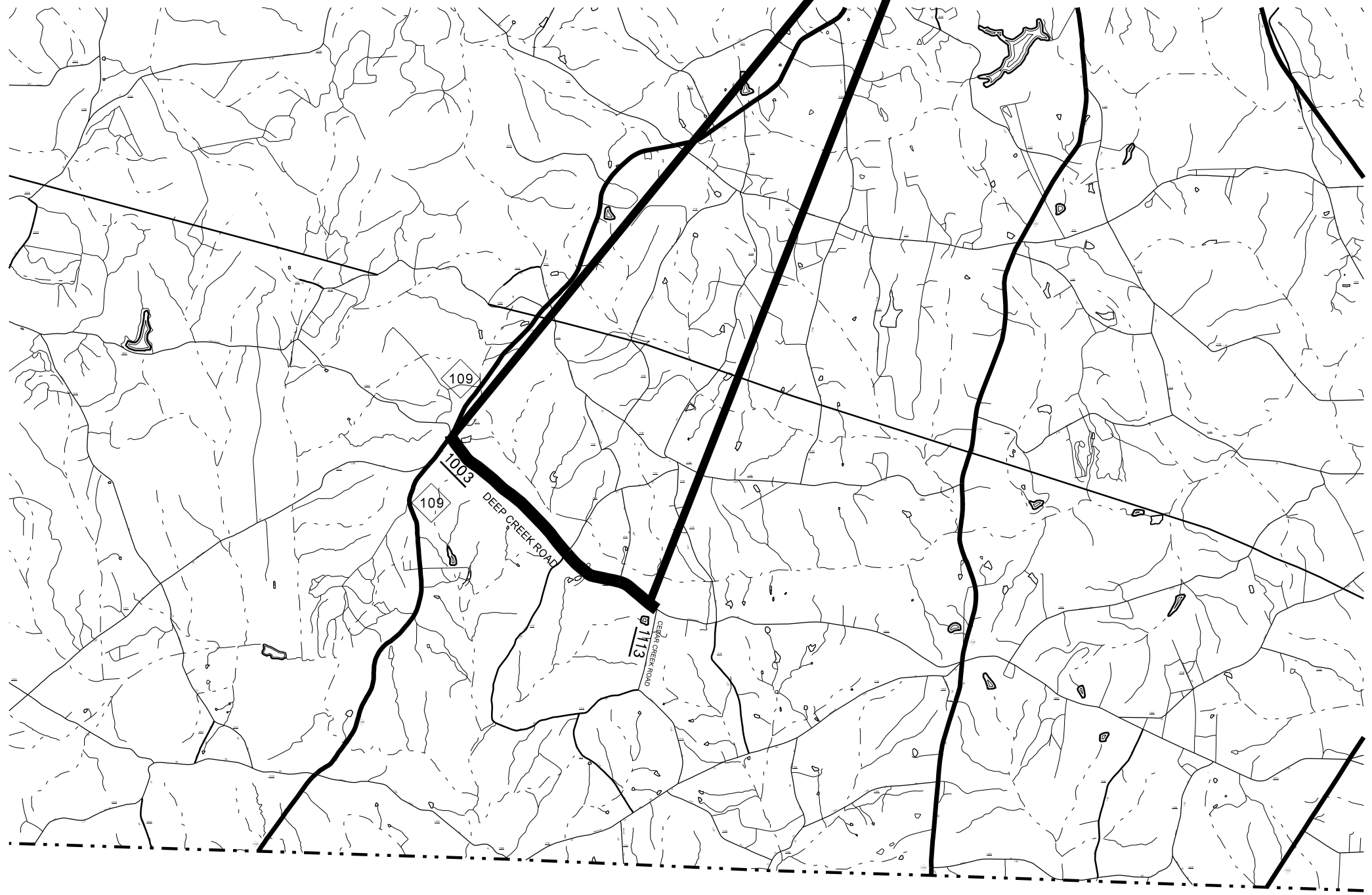

SOUTH CAROLINA

#6

STATE	PROJECT NO.	SHEET NO.	TOTAL SHEETS
N.C.	2018CPT.10.10.10041,I-ETC. 2018CPT.10.10.20041,I-ETC.	6	
F.A. PROJECT NO.			



ENLARGED MUNICIPAL AND SUBURBAN AREAS

ANSON COUNTY

NORTH CAROLINA

PREPARED BY THE
NORTH CAROLINA DEPARTMENT OF TRANSPORTATION
DIVISION OF HIGHWAYS - DIVISION 10 DISTRICT 3

MAP #6 SR 1455 EDWARDS STORE ROAD
2.1 MILES

FROM NC 218 TO
SR 1456 OLIVE BRANCH ROAD

UNION COUNTY

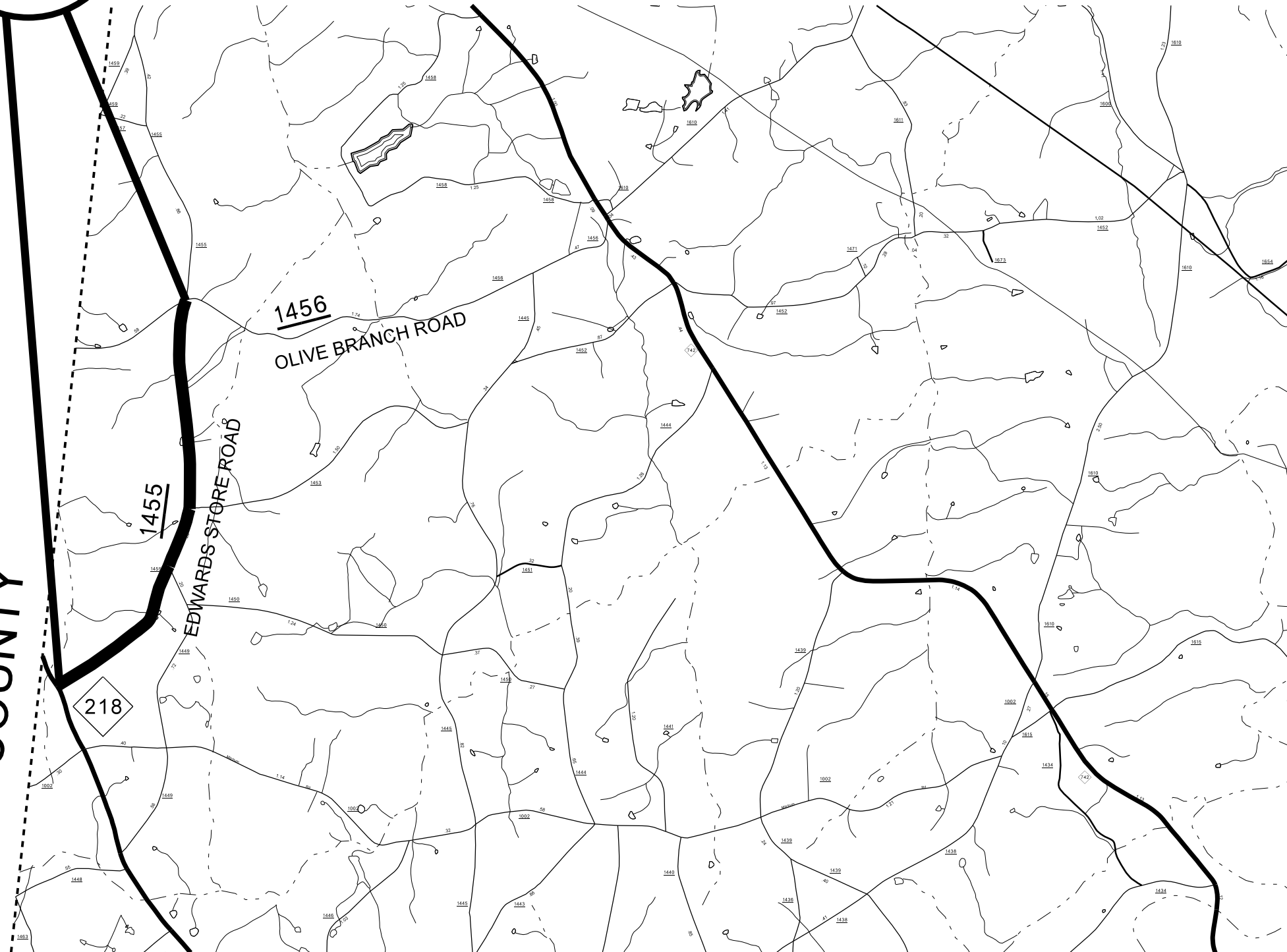

7

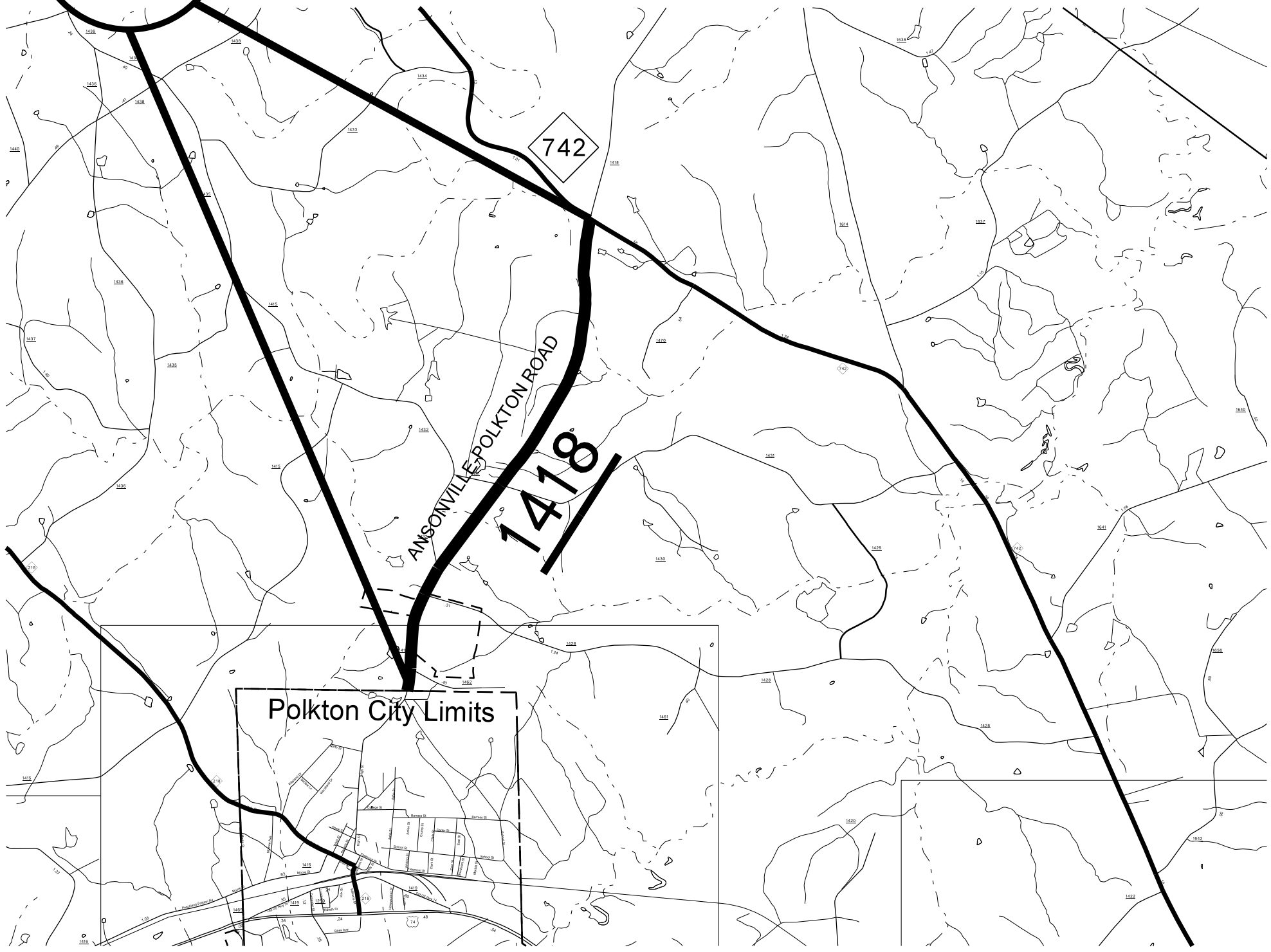

STATE	PROJECT NO.	SHEET NO.	TOTAL SHEETS
N.C.	2018CPT.10.10.10041.1-ETC. 2018CPT.10.10.20041.1-ETC.	7	
F.A. PROJECT NO.			

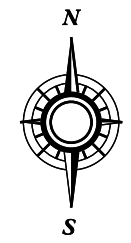

ENLARGED MUNICIPAL AND SUBURBAN AREAS
ANSON COUNTY
NORTH CAROLINA
PREPARED BY THE
NORTH CAROLINA DEPARTMENT OF TRANSPORTATION
DIVISION OF HIGHWAYS - DIVISION 10 DISTRICT 3

**MAP #7 SR 1418 ANSONVILLE-POLKTON ROAD
2.8 MILES**

**FROM NC 742 TO PAVEMENT JOINT
AT POLKTON CITY LIMITS**

STATE	PROJECT NO.	SHEET NO.	TOTAL SHEETS
N.C.	2018CPT.10.10.10041.1-ETC. 2018CPT.10.10.20041.1-ETC.	8	
F.A. PROJECT NO.			

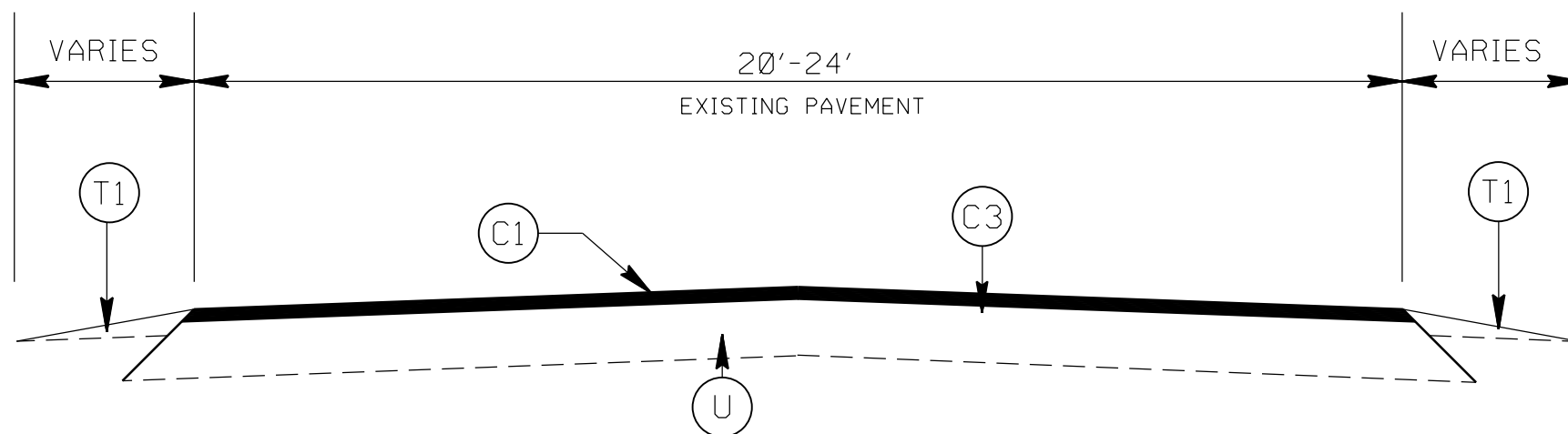

TYPICAL SECTION NO. 1
 NC 742 (MAP 1)
 SR 1121 WHITE STORE ROAD (MAP 3)
 *SEE NOTE 1

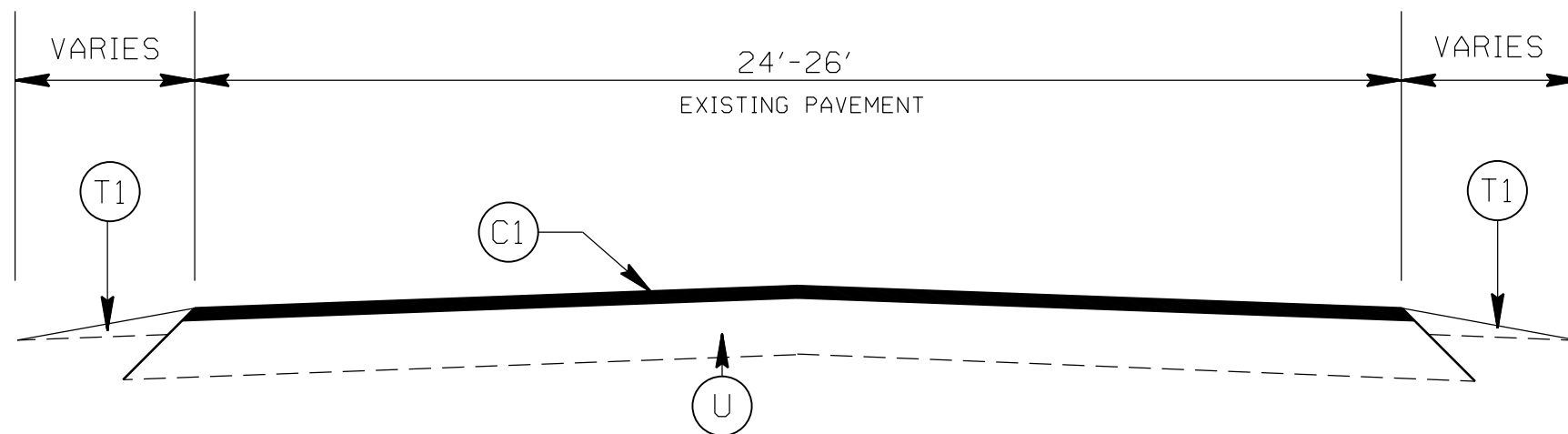

TYPICAL SECTION NO. 2
 NC 109 (MAP 2)

PAVEMENT SCHEDULE

(C1)	PROP. APPROX. 2.0" ASPHALT CONC. SURFACE COURSE, TYPE S9.5C, AT AN AVERAGE RATE OF 224 LBS. PER SQ. YD.
(C2)	PROP. APPROX. 1.5" ASPHALT CONC. SURFACE COURSE, TYPE S9.5C, AT AN AVERAGE RATE OF 168 LBS. PER SQ. YD.
(C3)	ASPHALT SURFACE TREATMENT, MAT COAT, NO. 67 STONE
(D1)	PROPOSED 2.5" ASPHALT CONC. INTERMEDIATE CORSE, TYPE I19.0C, AT AN AVERAGE RATE OF 285 LBS. PER SQ. YD.
(E1)	PROP. APPROX. 5" ASPHALT BASE COURSE, TYPE B25.0C, AT AN AVERAGE RATE OF 570 LBS PER SQYD.
(T1)	SHOULDER RECONSTRUCTION
(U)	EXISTING PAVEMENT
(V1)	MILLING 1' OF EXISTING PAVEMENT, 5" IN DEPTH. (SEE S.P. FOR "TRENCHING FOR BASE COURSE BY MILLING.")

2018-2019
 ANSON COUNTY RESURFACING

SCALE	-NA-		REVISIONS	
DATE	12/17			
DWG. BY	AMO			
DESIGN BY	AMO			
APPROVED	CLA			

STATE	PROJECT NO.	SHEET NO.	TOTAL SHEETS
N.C.	2018CPT.10.10.1004I.I-ETC. 2018CPT.10.10.2004I.I-ETC.	9	
F.A. PROJECT NO.			

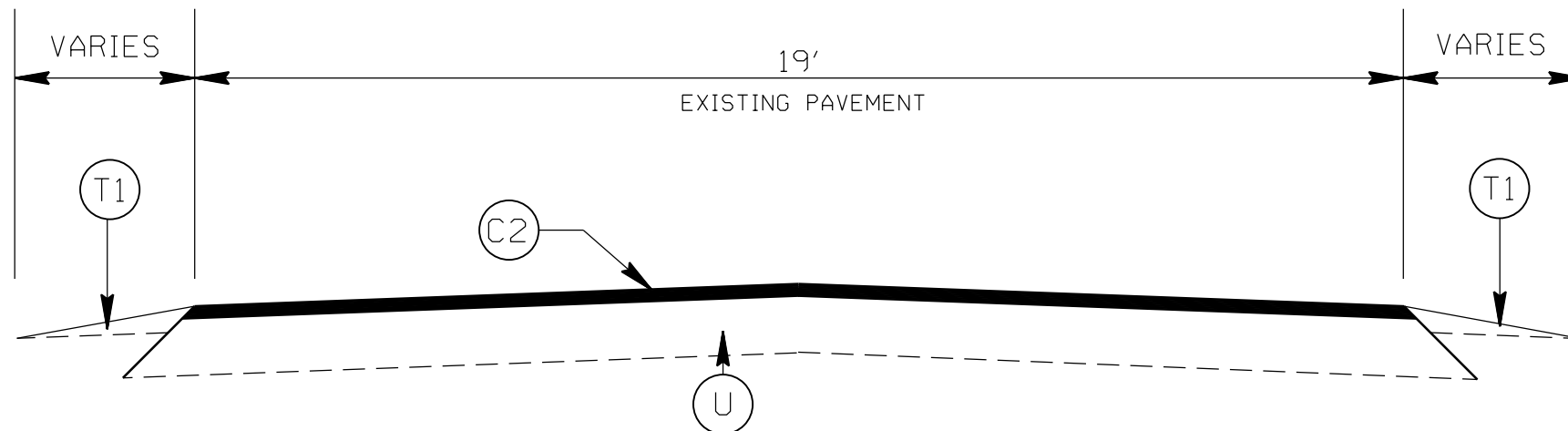

TYPICAL SECTION NO. 3
SR 1411 DEEP SPRINGS ROAD (MAP 4)

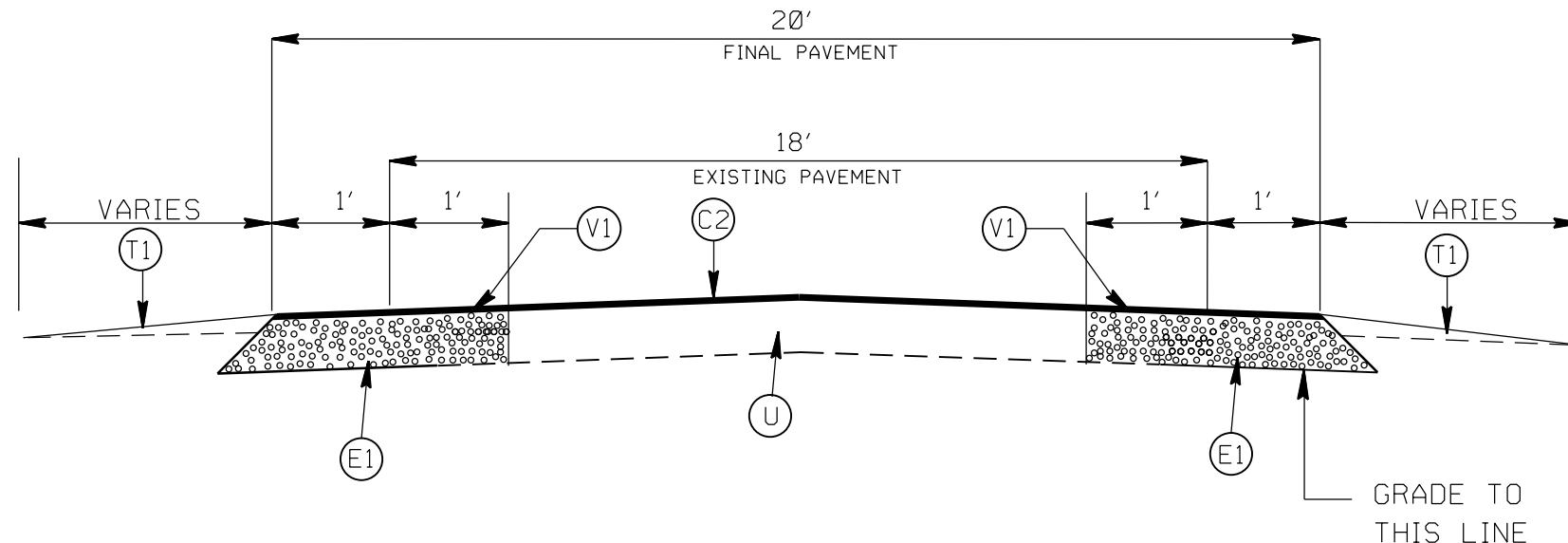

TYPICAL SECTION NO. 4
SR 1003 DEEP CREEK ROAD (MAP 5)
SR 1455 EDWARDS STORE ROAD (MAP 6)

PAVEMENT SCHEDULE

(C1)	PROP. APPROX. 2.0" ASPHALT CONC. SURFACE COURSE, TYPE S9.5C, AT AN AVERAGE RATE OF 224 LBS. PER SQ. YD.
(C2)	PROP. APPROX. 1.5" ASPHALT CONC. SURFACE COURSE, TYPE S9.5C, AT AN AVERAGE RATE OF 168 LBS. PER SQ. YD.
(C3)	ASPHALT SURFACE TREATMENT, MAT COAT, NO. 67 STONE
(D1)	PROPOSED 2.5" ASPHALT CONC. INTERMEDIATE CORSE, TYPE I19.0C, AT AN AVERAGE RATE OF 285 LBS. PER SQ. YD.
(E1)	PROP. APPROX. 5" ASPHALT BASE COURSE, TYPE B25.0C, AT AN AVERAGE RATE OF 570 LBS. PER SQ. YD.
(T1)	SHOULDER RECONSTRUCTION
(U)	EXISTING PAVEMENT
(V1)	MILLING 1" OF EXISTING PAVEMENT, 5" IN DEPTH. (SEE S.P. FOR "TRENCHING FOR BASE COURSE BY MILLING.")

2018-2019
ANSON COUNTY RESURFACING

SCALE	-1A-		REVISIONS
DATE	12/17		
DWG. BY	AMO		
DESIGN BY	AMO		
APPROVED	CLA		

STATE	PROJECT NO.	SHEET NO.	TOTAL SHEETS
N.C.	2018CPT.10.10.10041,1-ETC. 2018CPT.10.10.20041,1-ETC.	10	
F.A. PROJECT NO.			

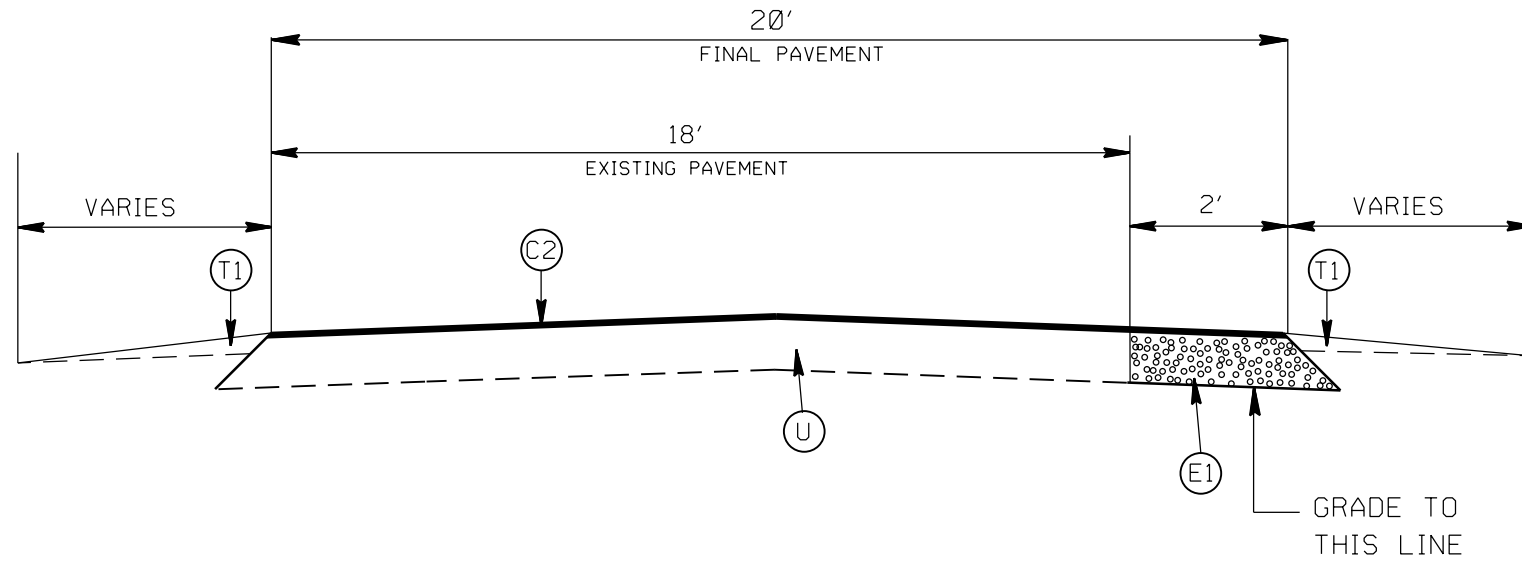

TYPICAL SECTION NO. 5
SR 1003 DEEP CREEK ROAD (MAP 5)
APPROX. STA: 59+00 TO STA: 68+00

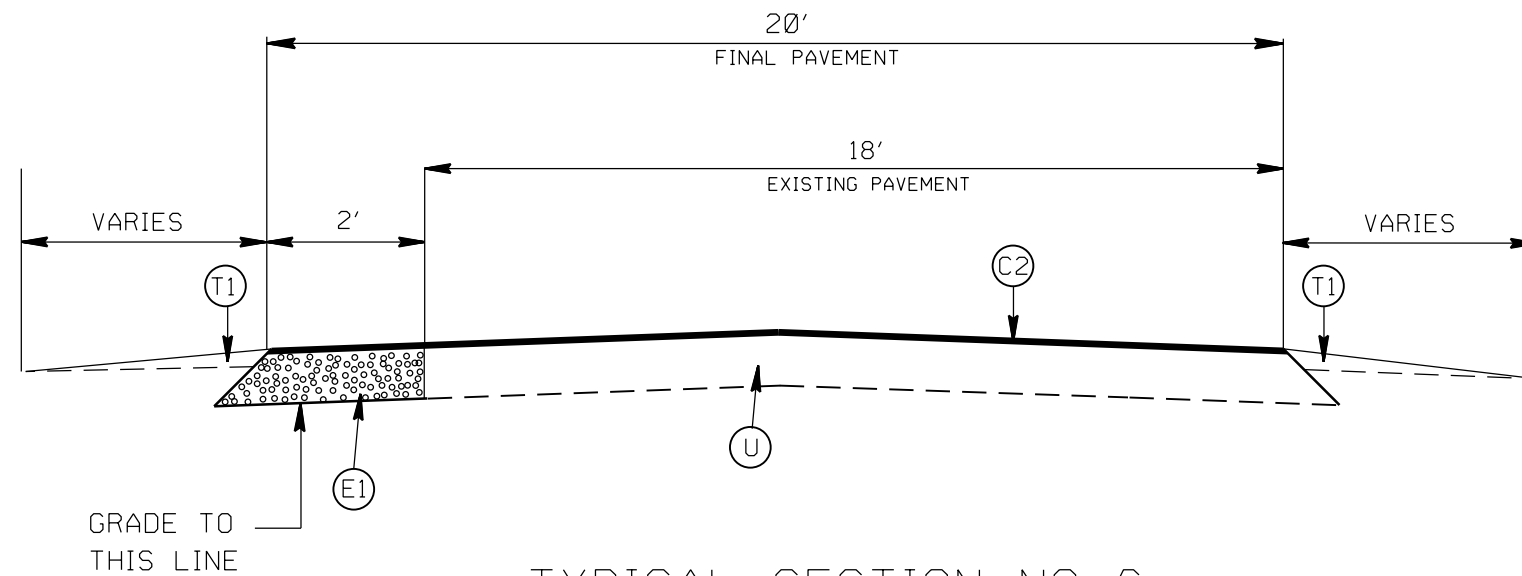

TYPICAL SECTION NO. 6
SR 1455 EDWARDS STORE ROAD (MAP 6)
APPROX. STA: 45+90 TO STA: 48+90
APPROX. STA: 71+85 TO STA: 76+35
APPROX. STA: 112+45 TO END OF MAP

PAVEMENT SCHEDULE

(C1)	PROP. APPROX. 2.0" ASPHALT CONC. SURFACE COURSE, TYPE S9.5C, AT AN AVERAGE RATE OF 224 LBS. PER SQ. YD.
(C2)	PROP. APPROX. 1.5" ASPHALT CONC. SURFACE COURSE, TYPE S9.5C, AT AN AVERAGE RATE OF 168 LBS. PER SQ. YD.
(C3)	ASPHALT SURFACE TREATMENT, MAT COAT, NO. 67 STONE
(D1)	PROPOSED 2.5" ASPHALT CONC. INTERMEDIATE CORSE, TYPE I19.0C, AT AN AVERAGE RATE OF 285 LBS. PER SQ. YD.
(E1)	PROP. APPROX. 5" ASPHALT BASE COURSE, TYPE B25.0C, AT AN AVERAGE RATE OF 570 LBS. PER SQ. YD.
(T1)	SHOULDER RECONSTRUCTION
(U)	EXISTING PAVEMENT
(V1)	MILLING 1" OF EXISTING PAVEMENT, 5" IN DEPTH. (SEE S.P. FOR "TRENCHING FOR BASE COURSE BY MILLING.")

2018-2019
ANSON COUNTY RESURFACING

SCALE	-NA-
DATE	12/17
DWG. BY	AMO
DESIGN BY	AMO
APPROVED	CLA



REVISIONS	

STATE	PROJECT NO.	SHEET NO.	TOTAL SHEETS
N.C.	2018CPT.10.10.1004I,1-ETC. 2018CPT.10.10.2004I,1-ETC.	11	
F.A. PROJECT NO.			

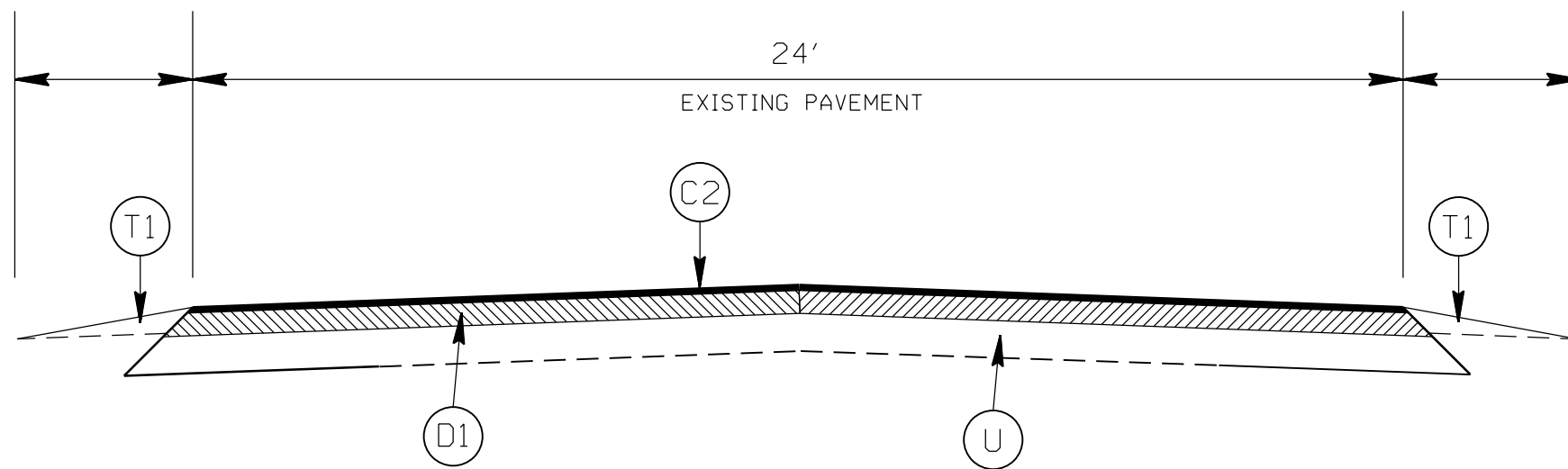

TYPICAL SECTION NO. 7
SR 1418 ANSONVILLE-POLKTON ROAD (MAP 9)

PAVEMENT SCHEDULE

(C1)	PROP. APPROX. 2.0" ASPHALT CONC. SURFACE COURSE, TYPE S9.5C, AT AN AVERAGE RATE OF 224 LBS. PER SQ. YD.
(C2)	PROP. APPROX. 1.5" ASPHALT CONC. SURFACE COURSE, TYPE S9.5C, AT AN AVERAGE RATE OF 168 LBS. PER SQ. YD.
(C3)	ASPHALT SURFACE TREATMENT, MAT COAT, NO. 67 STONE
(D1)	PROPOSED 2.5" ASPHALT CONC. INTERMEDIATE CORSE, TYPE I19.0C, AT AN AVERAGE RATE OF 285 LBS. PER SQ. YD.
(E1)	PROP. APPROX. 5" ASPHALT BASE COURSE, TYPE B25.0C, AT AN AVERAGE RATE OF 570 LBS PER SQYD.
(T1)	SHOULDER RECONSTRUCTION
(U)	EXISTING PAVEMENT
(V1)	MILLING 1" OF EXISTING PAVEMENT, 5" IN DEPTH. (SEE S.P. FOR "TRENCHING FOR BASE COURSE BY MILLING.")

2018-2019
ANSON COUNTY RESURFACING

SCALE	-NA-
DATE	12/17
DWG. BY	AMO
DESIGN BY	AMO
APPROVED	CLA



REVISIONS	

STATE	PROJECT NO.	SHEET NO.	TOTAL SHEETS
N.C.	2018CPT.10.10.1004I.I-ETC. 2018CPT.10.10.2004I.I-ETC.	12	
F.A. PROJECT NO.			

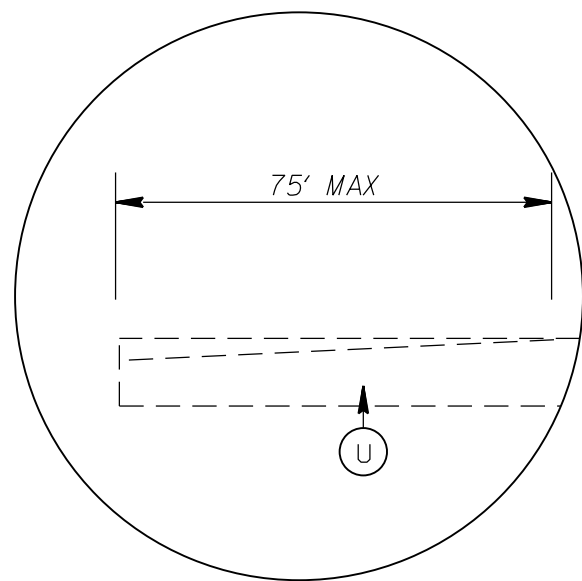

DETAIL FOR INCIDENTAL MILLING (0" TO 2.0")

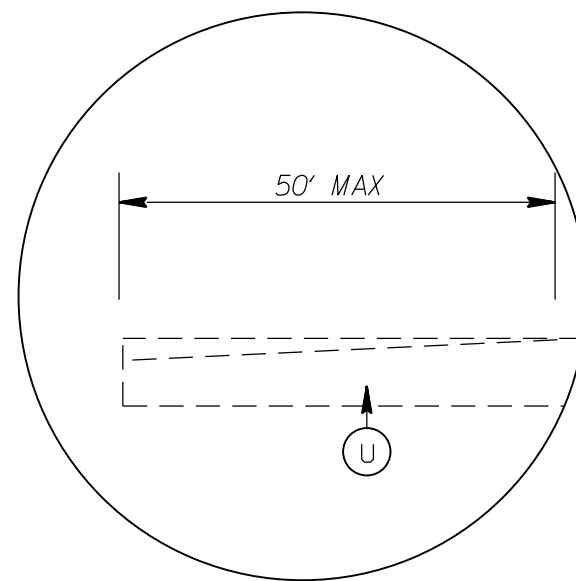

DETAIL FOR INCIDENTAL MILLING (0" TO 1.5")

PAVEMENT SCHEDULE

(C1)	PROP. APPROX. 2.0" ASPHALT CONC. SURFACE COURSE, TYPE S9.5C, AT AN AVERAGE RATE OF 224 LBS. PER SQ. YD.
(C2)	PROP. APPROX. 1.5" ASPHALT CONC. SURFACE COURSE, TYPE S9.5C, AT AN AVERAGE RATE OF 168 LBS. PER SQ. YD.
(C3)	ASPHALT SURFACE TREATMENT, MAT COAT, NO. 67 STONE
(D1)	PROPOSED 2.5" ASPHALT CONC. INTERMEDIATE CORSE, TYPE I19.0C, AT AN AVERAGE RATE OF 285 LBS. PER SQ. YD.
(E1)	PROP. APPROX. 5" ASPHALT BASE COURSE, TYPE B25.0C, AT AN AVERAGE RATE OF 570 LBS PER SQYD.
(T1)	SHOULDER RECONSTRUCTION
(U)	EXISTING PAVEMENT
(V1)	MILLING 1' OF EXISTING PAVEMENT, 5" IN DEPTH. (SEE S.P. FOR "TRENCHING FOR BASE COURSE BY MILLING.")

PATCHING DETAIL

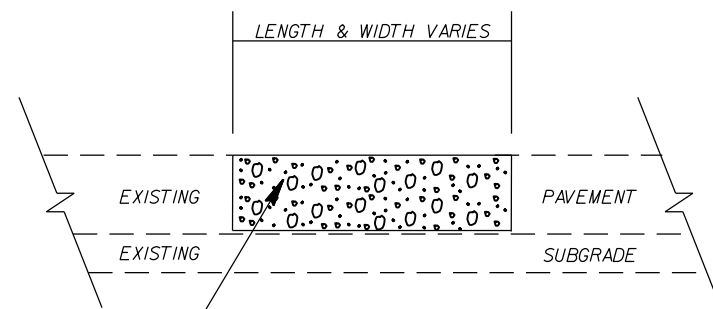

RATE IS VARIABLE AND SHALL BE AS DIRECTED BY THE ENGINEER. ASPHALT TYPE I19.0C SHALL BE PLACED.

NOTES:

1. ON MAP 1, SKIP BRIDGE. ON MAP 3, MILL AND FILL BRIDGE WITH 1.5" S9.5C

2: SHOULDER RECONSTRUCTION WILL BE AS DIRECTED BY THE ENGINEER.

2018-2019
ANSON COUNTY RESURFACING

SCALE	-NA-		REVISIONS
DATE	12/17		
DWG. BY	AMO		
DESIGN BY	AMO		
APPROVED	CLA		

NOTES:

- 1) DETAIL DOES NOT APPLY TO OGAF C AND ULTRA-THIN BONDED WEARING COURSE.
- 2) BACKFILL SHOULDER WITH APPROVED MATERIAL.
- 3) THE SHOULDER WEDGE DEVICE MAY BE DISENGAGED AT PAVED DRIVEWAYS AND SIDE STREETS.

STATE	PROJECT NO.	SHEET NO.	TOTAL SHEETS
N.C.	2018CPT.10.10.1004I.1-ETC. 2018CPT.10.10.2004I.1-ETC.	13	
F.A. PROJECT NO.			

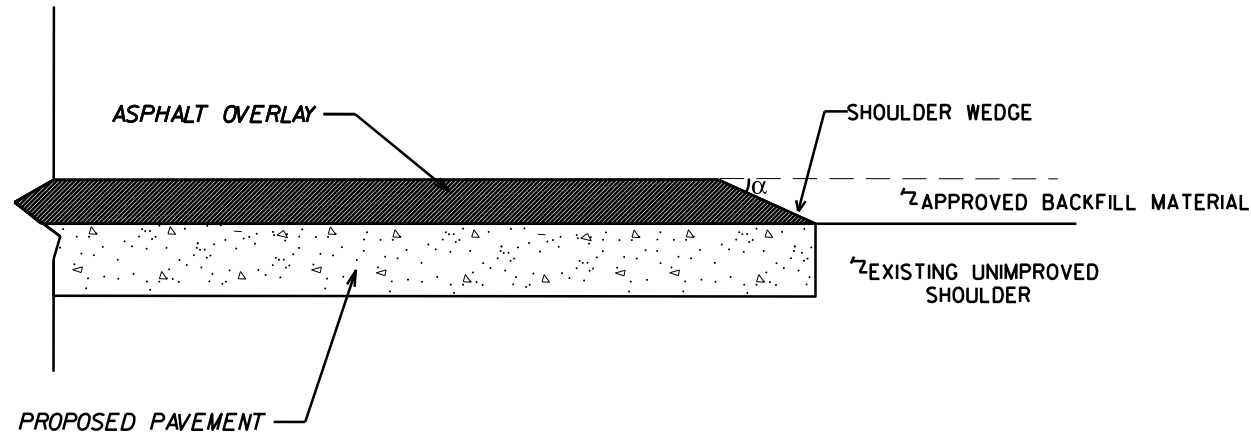

SHOULDER WEDGE DETAIL

(RESURFACING PROJECTS W/ WIDENING OR WITH EXISTING PAVED SHOULDER HAVING NO DROPOFFS)

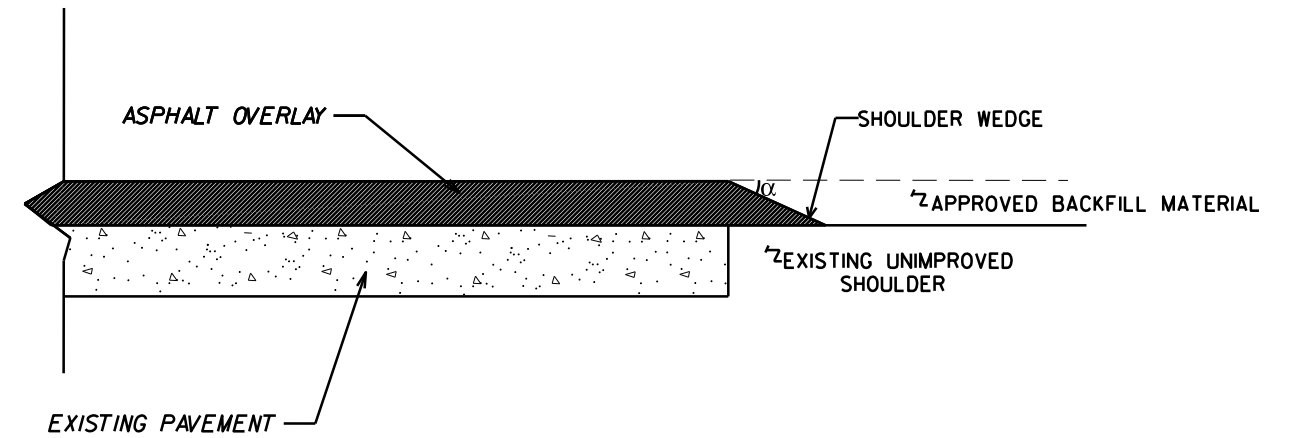

SHOULDER WEDGE DETAIL

(RESURFACING PROJECTS W/ NO WIDENING)

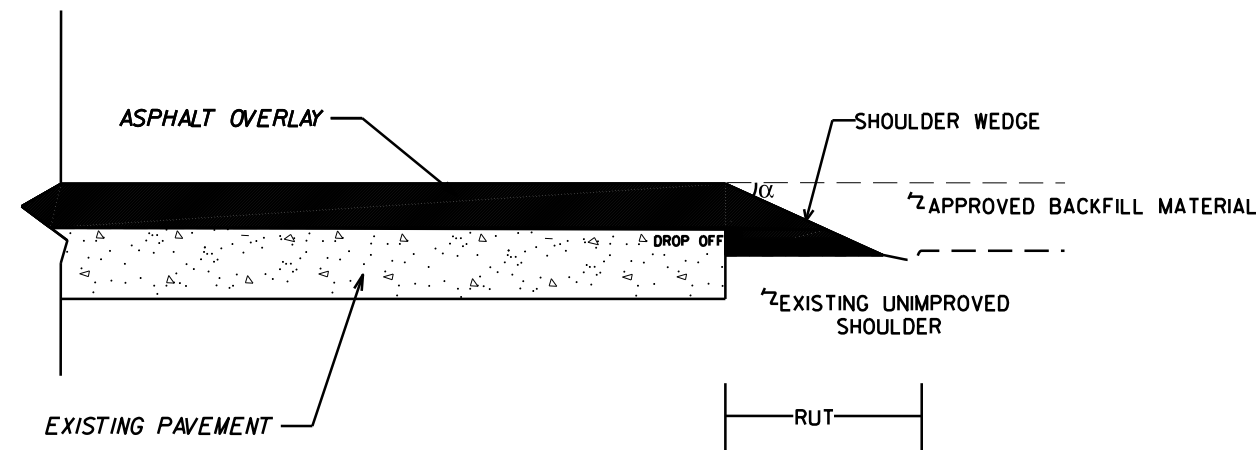

SHOULDER WEDGE DETAIL
(RESURFACING ADJACENT TO RUTTED SHOULDER)

$\alpha = 30$ DEGREES

SHOULDER WEDGE DETAILS		
SCALE	-NA-	REVISIONS
DATE	12/17	
DWG. BY	AMO	
DESIGN BY	AMO	
APPROVED	CLA	



PROJECT NO.	SHEET NO.	TOTAL NO.
2018CPT.10.10.10041.1-ETC.	14	18
2018CPT.10.10.20041.1-ETC.		

SUMMARY OF QUANTITIES

PROJECT NO	COUNTY	MAP NO	ROUTE	DESCRIPTION	TYP NO	LANES	LANE TYPE	FINAL SURFACE TESTING REQUIRED	WARM MIX ASPHALT REQUIRED	LENGTH	WIDTH	0106000000-E	1220000000-E	1245000000-E	1297000000-E	1330000000-E	1491000000-E	1503000000-E	1523000000-E	1524000000-E	1575000000-E	1704000000-E	1775000000-E	1838000000-E	2612000000-E	6000000000-E	6090000000-E	6012000000-E	6071010000-E	6071020000-E		
												BORROW	INCIDENTAL STONE BASE	SHOULDER RECONSTRUCTION	2" MILLING	INCIDENTAL MILLING	BASE COURSE, 825.0C	INTERMEDIATE COURSE, 119.0C	SURFACE COURSE, 59.5C	LEVELING COURSE, 59.5C	ASPHALT BINDER FOR PLANT MIX	PATCHING EXISTING PAVEMENT	ASPHALT SURFACE TREATMENT, MATCOAT, #67 STONE	EMULSION FOR ASPHALT SURFACE TREATMENT	6" DRIVEWAYS	TEMPORARY SILT FENCE	STONE FOR EROSION CONTROL, CLASS B	SEDIMENT CONTROL STONE	WATTLE	POLYACRYLAMIDE (PAM)		
												MI	FT	CY	TONS	SMI	SY	SY	TONS	TONS	TONS	TONS	TONS	TONS	SY	GAL	SY	LF	TN	TN	LF	LB
2018CPT.10.10.10041.1	Anson	1	NC 742/ROUTE 30000742	FROM PVMT JT AT BRIDGE TO NC 109 RIVER MILEPOST 7.86 TO 10.66	1	2	2WU	NO	NO	2.8	23	571	240	5.60	240	436		4,690		281	1,125	37,357	13,075	350	422	56	28	422	1			
TOTAL FOR MAP NO. 1												2.8		571	240	5.60	240	436		4,690		281	1,125	37,357	13,075	350	422	56	28	422	1	
2018CPT.10.10.10041.2	Anson	2	NC 109/ROUTE 30000109	FROM PVMT JT AT SR 1710 ALLEN STREET TO BRIDGE OVER PEE DEE RIVER MILEPOST 19.72 TO 23.62	2	2	2WU	NO	NO	3.9	25	792	75	7.80		460		6,979	1,716	522	1,560			75	585	78	39	585	2			
TOTAL FOR MAP NO. 2												3.9		792	75	7.80		460		6,979	1,716	522	1,560			75	585	78	39	585	2	
2018CPT.10.10.20041.1	Anson	3	SR 1121 WHITE STORE ROAD/ ROUTE 40001121	FROM SR 1121 PRISON CAMP ROAD TO PVMT JT AT SR 1121 CAMDEN CHURCH ROAD MILEPOST 3.68 TO 4.68	1	2	2WU	NO	NO	1	20	205	70	2.00	180	334		1,456		87	450	11,816	4,135		150	20	10	150	0			
TOTAL FOR MAP NO. 3												1		205	70	2.00	180	334		1,456		87	450	11,816	4,135		150	20	10	150	0	
2018CPT.10.10.20041.2	Anson	4	SR 1411 DEEP SPRINGS ROAD/ROUTE 40001411	FROM SR 1413 NEWTON MOORE ROAD TO NC 218 MILEPOST 2 TO 3.6	3	2	2WU	NO	NO	1.6	19	248	110	3.20		220		1,694	713	144	729			25	243	32	16	243	1			
TOTAL FOR MAP NO. 4												1.6		248	110	3.20		220		1,694	713	144	729			25	243	32	16	243	1	
2018CPT.10.10.20041.3	Anson	5	SR 1003 DEEP CREEK ROAD/ROUTE 40001003	FROM NC 109 SOUTH TO SR 1113 CEDAR CREEK ROAD MILEPOST 8.67 TO 11.27	4 & 5	2	2WU	NO	NO	2.6	18.5	400	145	5.20	252	1,915		3,008	1,144	335	1,040			50	780	78	39	780	1			
TOTAL FOR MAP NO. 5												2.6		400	145	5.20	252	1,915		3,008	1,144	335	1,040			50	780	78	39	780	1	
2018CPT.10.10.20041.4	Anson	6	SR 1455 EDWARDS STORE ROAD/ROUTE 40001455	FROM NC 218 TO SR 1456 OLIVE BRANCH ROAD MILEPOST 0 TO 2.1	4 & 6	2	2WU	NO	NO	2.1	18	315	85	4.10	238	1,520		2,396	910	267	828			100	621	62	31	621	1			
TOTAL FOR MAP NO. 6												2.1		315	85	4.10	238	1,520		2,396	910	267	828			100	621	62	31	621	1	
2018CPT.10.10.20041.5	Anson	7	SR 1418 ANSONVILLE-POLKTON ROAD/ROUTE 40001418	FROM NC 742 TO PVMT JOINT AT POLKTON CITY LIMITS FROM MILEPOST 5.82 TO 8.62	7	2	2WU	NO	NO	2.8	24	577	270	5.70	320		6,250	3,795	528	1,274			100	425	57	28	425	1				
TOTAL FOR MAP NO. 7												2.8		577	270	5.70	320		6,250	3,795	528	1,274			100	425	57	28	425	1		
GRAND TOTAL												16.8		3,108	995	33.60	420	2,260	3,435	6,250	24,018	4,483	2,164	7,006	49,173	17,210	700	3,226	383	191	3,226	7

Note: The Contractor shall not park any equipment or work outside of the existing right of way in historic areas.

PROJECT NO.	SHEET NO.	TOTAL NO.
2018CPT.10.10.10041.1-ETC.	15	18
2018CPT.10.10.20041.1-ETC.		

THERMOPLASTIC AND PAINT QUANTITIES

PROJECT NO	COUNTY	MAP NO	ROUTE	DESCRIPTION	TYP NO	LANES	LANE TYPE	LENGTH	WIDTH	4413000000-E	4457000000-N	4510000000-N	4810000000-E	4835000000-E	4840000000-N	4905000000-N			
										WORK ZONE ADVANCE/GENERAL WARNING SIGNING	TEMPORARY TRAFFIC CONTROL	LAW ENFORCEMENT	4" WHITE PAINT	4" YELLOW PAINT	24" WHITE PAINT	PAINT MSG STOP	PAINT MSG AHEAD	SNOW PLOWABLE MARKERS	
									MI	FT	SF	LS	HR	LF	LF	LF	EA	EA	EA
2018CPT.10.10.10041.1	Anson	1	NC 742/ROUTE 30000742	FROM PVMT JT AT BRIDGE TO NC 109 MILEPOST 7.86 TO 10.66	1	2	2WU	2.8	23	319.0	1.00	20.00	29,614	28,882	20				186
TOTAL FOR MAP NO. 1									2.8		319.0	1.00	20	29,614	28,882	20			186
2018CPT.10.10.10041.2	Anson	2	NC 109/ROUTE 30000109	FROM PVMT JT AT SR 1710 ALLEN STREET TO BRIDGE OVER PEE DEE RIVER MILEPOST 19.72 TO 23.62	2	2	2WU	3.9	25	319.0	*		41,094	34,446					257
TOTAL FOR MAP NO. 2									3.9		319.0			41,094	34,446				257
2018CPT.10.10.20041.1	Anson	3	SR 1121 WHITE STORE ROAD/ ROUTE 40001121	FROM SR 1121PRISON CAMP ROAD TO PVMT JT AT SR 1121 CAMDEN CHURCH ROAD MILEPOST 3.68 TO 4.68	1	2	2WU	1	20		*		10,634	10,298					
TOTAL FOR MAP NO. 3									1					10,634	10,298				
2018CPT.10.10.20041.2	Anson	4	SR 1411 DEEP SPRINGS ROAD/ROUTE 40001411	FROM SR 1413 NEWTON MOORE ROAD TO NC 218 MILEPOST 2 TO 3.6	3	2	2WU	1.6	19		*		17,146	14,797					
TOTAL FOR MAP NO. 4									1.6					17,146	14,797				
2018CPT.10.10.20041.3	Anson	5	SR 1003 DEEP CREEK ROAD/ROUTE 40001003	FROM NC 109 SOUTH TO SR 1113 CEDAR CREEK ROAD MILEPOST 8.67 TO 11.27	4 & 5	2	2WU	2.6	18.5	319.0	*		27,492	23,614					
TOTAL FOR MAP NO. 5									2.6		319.0			27,492	23,614				
2018CPT.10.10.20041.4	Anson	6	SR 1455 EDWARDS STORE ROAD/ROUTE 40001455	FROM NC 218 TO SR 1456 OLIVE BRANCH ROAD MILEPOST 0 TO 2.1	4 & 6	2	2WU	2.1	18	319.0	*		21,824	20,998					
TOTAL FOR MAP NO. 6									2.1		319.0			21,824	20,998				
2018CPT.10.10.20041.5	Anson	7	SR 1418 ANSONVILLE-POLKTON ROAD/ROUTE 40001418	FROM NC 742 TO PVMT JOINT AT POLKTON CITY LIMITS FROM MILEPOST 5.82 TO 8.62	7	2	2WU	2.8	24	319.0	*		29,906	52,624	26	8	5		187
TOTAL FOR MAP NO. 7									2.8		319			29,906	52,624	26	8	5	187
GRAND TOTAL									16.8		1,595	1	20	177,710	185,659	46	8	5	630
													363,369			13			

NOTE: The Contractor shall install Temporary Paint Pavement Markings in accordance with Section 1205-8(C) of the 2018 Standard Specifications.

SIGNING FOR RESURFACING PROJECTS

LEGEND
 STATIONARY SIGN
 DIRECTION OF TRAFFIC FLOW

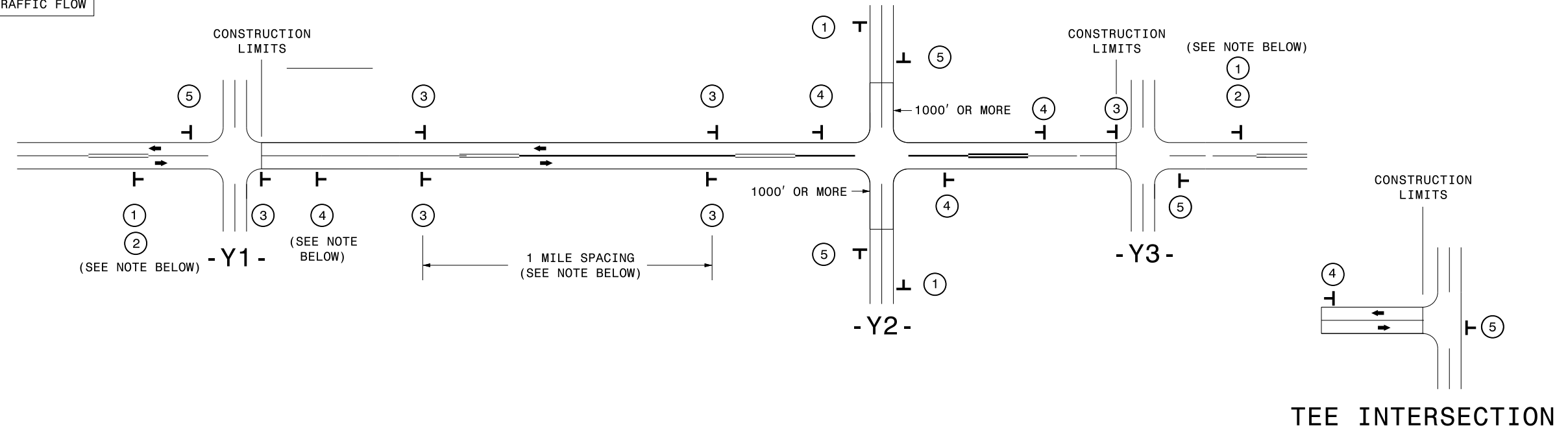

MAINLINE (-L-) SIGNING

-Y- LINE SIGNING

SIGNING NOTES AND PLACEMENT PER DIRECTION	①		PLACE 1000' PRIOR TO BEGINNING OF CONSTRUCTION LIMITS. ONLY USED ON -Y- LINES IF RESURFACING LIMITS EXTEND 1000' ALONG -Y- LINE.
	②		#2 SIGN ONLY USED WHEN CONSTRUCTION LIMITS ARE 2 OR MORE MILES IN LENGTH. ROUND UP TO NEXT WHOLE NUMBER. (NO FRACTIONAL OR DECIMAL NUMBERS)
	③		- PLACE INITIALLY AT THE CONSTRUCTION LIMITS AND SPACE 1 MILE APART THEREAFTER. - AT TEE INTERSECTIONS INSTALL INITIALLY 1/2 MILE FROM INTERSECTION AND SPACE 1 MILE APART THEREAFTER.
	④		- THESE ARE FOR -Y- LINES THAT ARE "THROUGH" ROADWAYS. - DEAD END AND SUBDIVISION ROADS ARE NOT "THROUGH" ROADWAYS. - INSTALL 500' +/- FROM EACH -Y- LINE APPROACH AS SHOWN ABOVE. - FOR MULTIPLE -Y- LINES THAT ARE SEPARATED BY 0.25 MILES OR LESS, TREAT AS A SINGLE UNIT AND INSTALL WITHIN 500' OF EACH APPROACH. - A MAXIMUM OF 2 SIGN SETS PER MILE. DO NOT INSTALL WHEN -Y- LINES ARE WITHIN 0.5 MILES FROM "END ROAD WORK" SIGN. - FOR TEE INTERSECTIONS, INSTALL WITHIN 500' +/- OF THE INTERSECTION ALONG -L- LINE.
	⑤		PLACE 500' FOLLOWING THE END OF CONSTRUCTION LIMITS OR AS SHOWN WHEN WORK ENDS AT A 3-WAY TEE INTERSECTION.

NO REQUIRED STATIONARY SIGNING FOR THE FOLLOWING -Y- LINE CONDITIONS:

- 1) LESS THAN 1000' OF RESURFACING ALONG -Y- LINE
- 2) SUBDIVISION ROADS
- 3) DEAD END ROADS

WHEN PAVING/CONSTRUCTION ACTIVITIES PROCEED ACROSS AN UNSIGNED -Y- LINE, PORTABLE ADVANCE WARNING SIGNS SHALL BE USED ALONG THE -Y- LINE AS SHOWN BELOW. REMOVE UPON COMPLETION OF WORK.

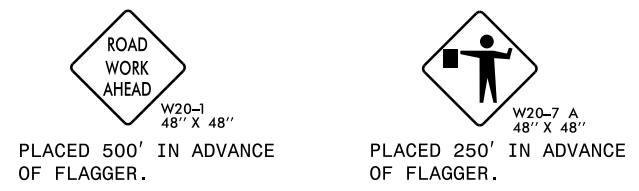

THE ABOVE SIGNS ARE ALL THAT ARE REQUIRED FOR A CONTRACTOR TO BEGIN A RESURFACING CONTRACT. ANY ADDITIONAL SIGNS REQUESTED BY NCDOT DIVISIONS SHALL BE INSTALLED WITHIN 7 BUSINESS DAYS OF THE START OF CONTRACT WORK.

MAPS LESS THAN 2 MILES

FOR RESURFACING MAPS WITH CONSTRUCTION LIMITS LESS THAN 2 MILES IN LENGTH, NO STATIONARY SIGNS ARE REQUIRED. USE PORTABLE "ROAD UNDER CONSTRUCTION" OR "ROAD WORK AHEAD" SIGNS IN LIEU OF STATIONARY ADVANCE WARNINGS SIGNS.



**ADVANCE WARNING SIGNS
FOR
RURAL AND SUBURBAN
2-LANE ROADWAY
RESURFACING**

20-JAN-2018 13:57 C:\Users\skou\Documents\My Documents\CONTRACTS\Resurfacing_Raleigh Let Contract\2018-2019\Anson\Contract #2\Resurfacing_Typicals\ANSON 2018-2019.dgn

NOTES: LESS THAN 5' - 10' UNDISTURBED BUFFER FROM ROW, DITCHLINE, WATER FEATURE, OR DRAINAGE INLET, ADD BMP.

BMP OPTIONS: WATTLE OR SILT FENCE

STATE	PROJECT NO.	SHEET NO.	TOTAL SHEETS
N.C.	2018CPT.10.10.1004I,1-ETC. 2018CPT.10.10.2004I,1-ETC.	17	
F.A. PROJECT NO.			

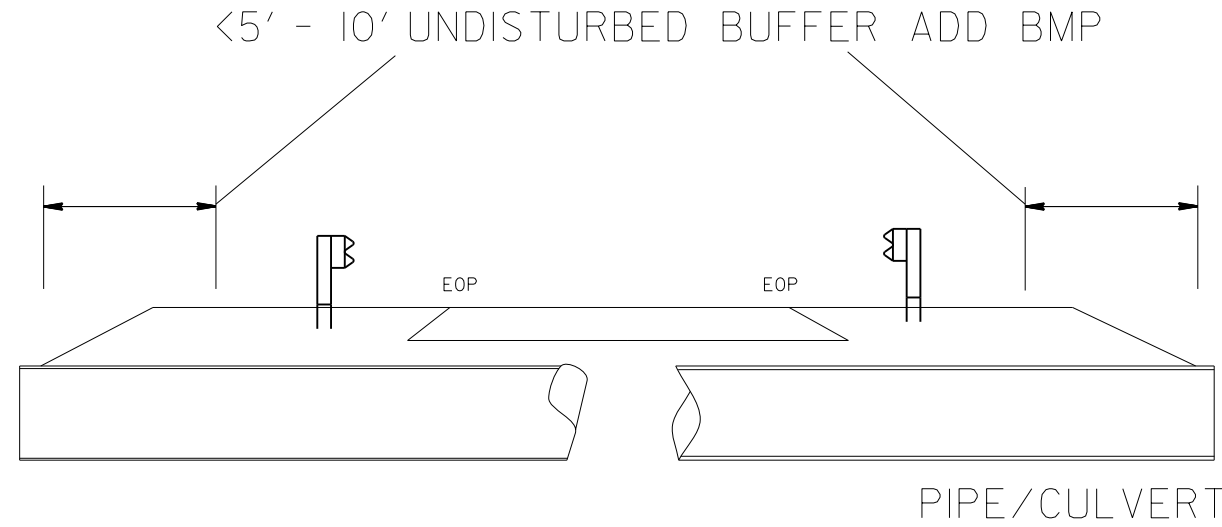

<5' - 10' UNDISTURBED BUFFER FROM JURISDICTIONAL FEATURE ADD BMP

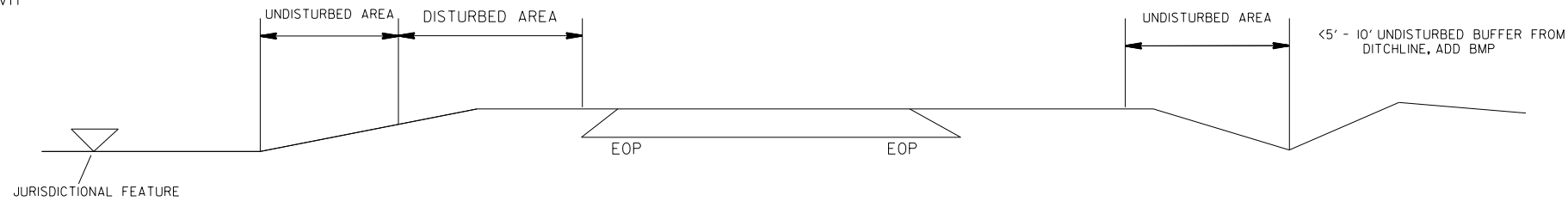

USE BMP'S IF SHOULDERS AND/OR FRONTSLOPES AND/OR DITCHLINE AND/OR BACKSLOPES ARE DISTURBED

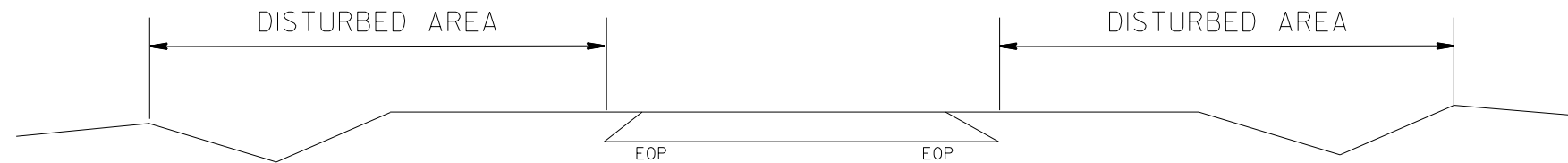

<5' - 10' UNDISTURBED BUFFER FROM INLET, ADD WATTLE

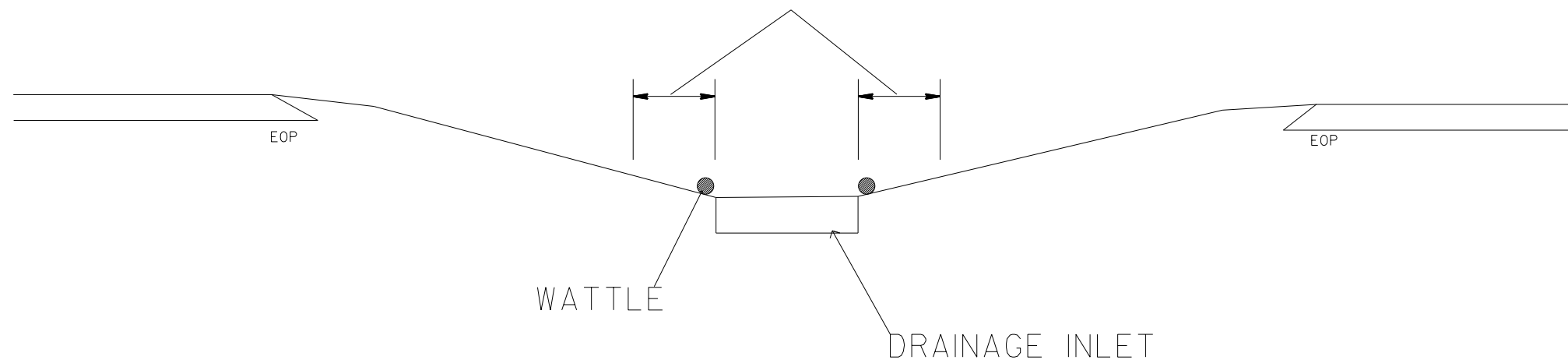

EROSION CONTROL DETAIL

SCALE	-NA-		REVISIONS	
DATE	12/17			
DWG. BY	AMO			
DESIGN BY	AMO			
APPROVED	CLA			

WATTLE WITH POLYACRYLAMIDE DETAIL

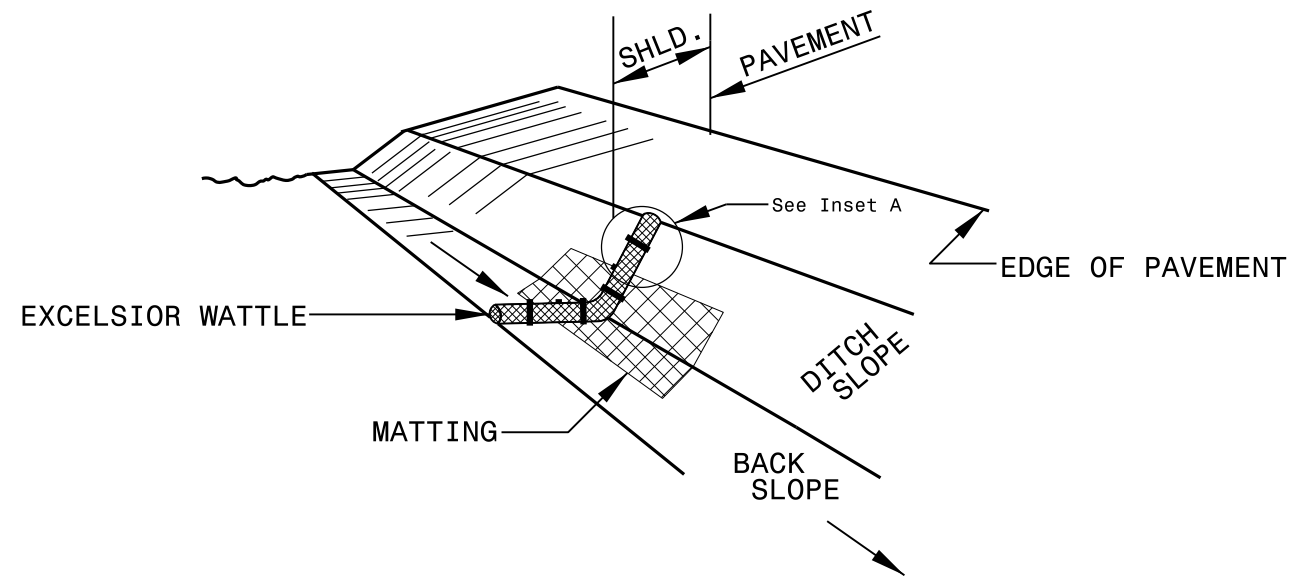

ISOMETRIC VIEW

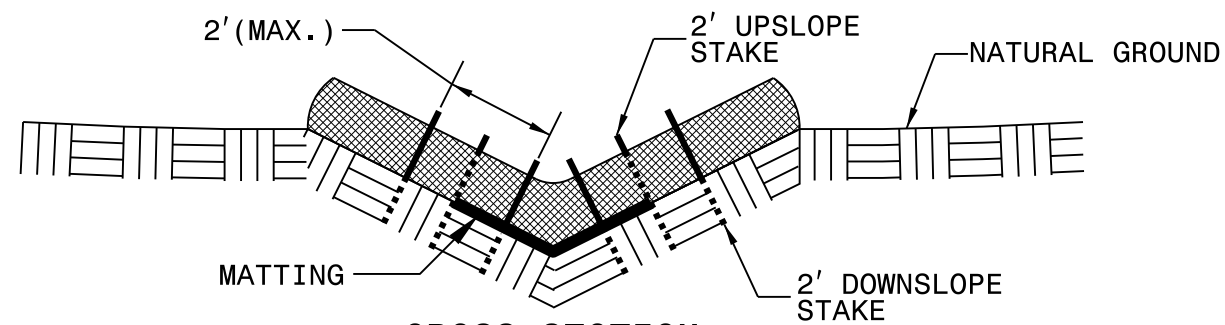

**CROSS SECTION
VEE DITCH**

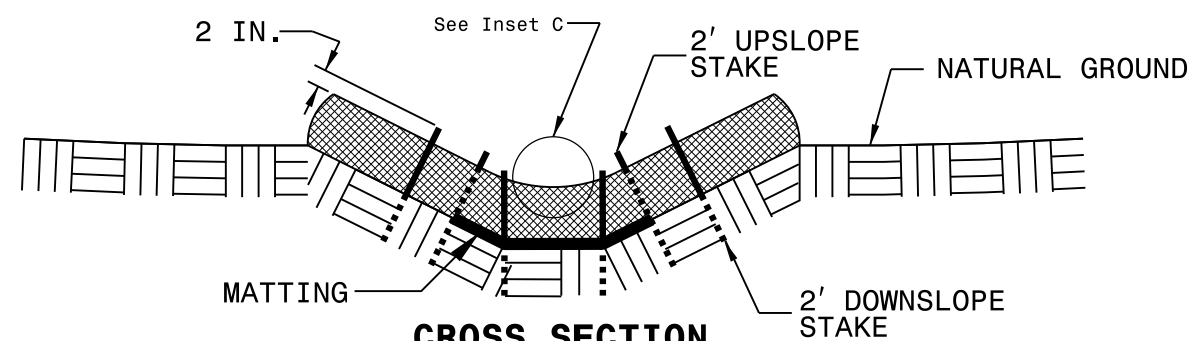

**CROSS SECTION
TRAPEZOIDAL DITCH**

NOTES:

USE MINIMUM 12 IN. DIAMETER EXCELSIOR WATTLE.

USE 2 FT. WOODEN STAKES WITH A 2 IN. BY 2 IN. CROSS SECTION.

INSTALL A MINIMUM OF 2 UPSLOPE STAKES AND 4 DOWNSLOPE STAKES AT AN ANGLE TO WEDGE WATTLE TO BOTTOM OF DITCH.

PROVIDE STAPLES MADE OF 0.125 IN. DIAMETER STEEL WIRE FORMED INTO A U SHAPE NOT LESS THAN 12" IN LENGTH.

INSTALL STAPLES APPROXIMATELY EVERY 1 LINEAR FOOT ON BOTH SIDES OF WATTLE AND AT EACH END TO SECURE IT TO THE SOIL.

INSTALL MATTING IN ACCORDANCE WITH SECTION 1631 OF THE STANDARD SPECIFICATIONS.

PRIOR TO POLYACRYLAMIDE (PAM) APPLICATION, OBTAIN A SOIL SAMPLE FROM PROJECT LOCATION, AND FROM OFFSITE MATERIAL, AND ANALYZE FOR APPROPRIATE PAM FLOCCULANT TO BE APPLIED TO EACH WATTLE.

INITIALLY APPLY 3.5 OUNCES OF ANIONIC OR NEUTRALLY CHARGED POLYACRYLAMIDE (PAM) OVER WATTLE WHERE WATER WILL FLOW AND AFTER EVERY RAINFALL EVENT THAT IS EQUAL TO OR EXCEEDS 0.50 IN.

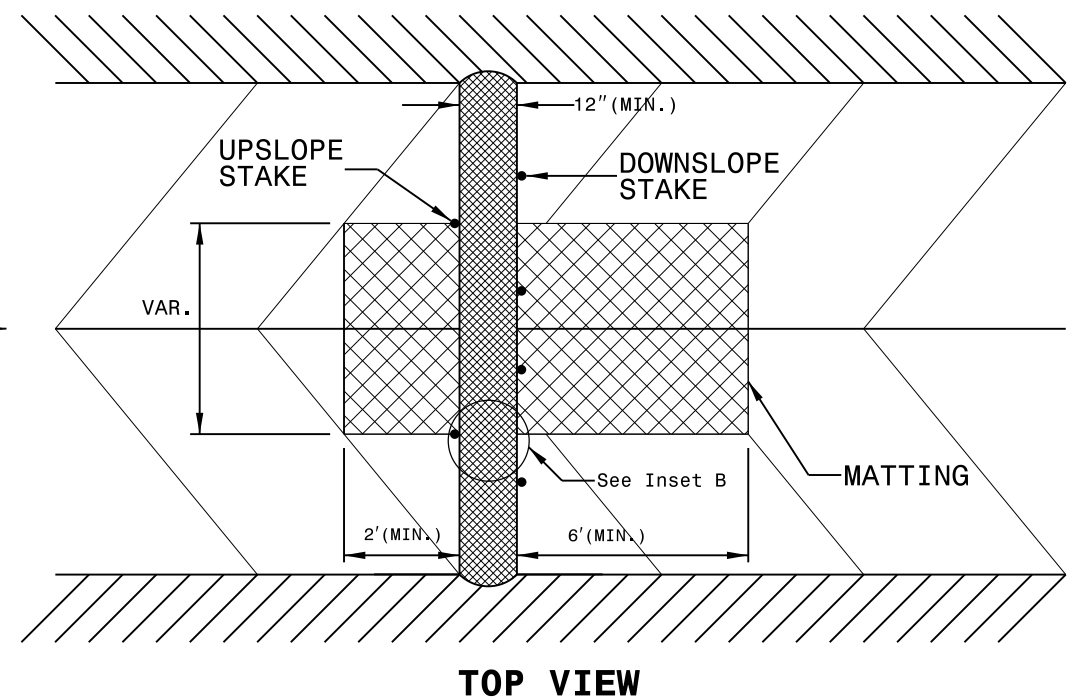
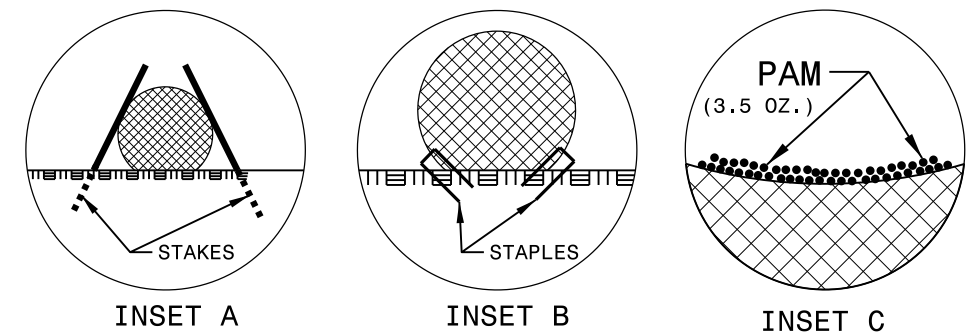

TOP VIEW